

# Seal Solutions Inc.

3103 Cascade Drive  
Valparaiso, IN 46383  
PH: (219) 246-1302  
[www.sealsolutionsinc.com](http://www.sealsolutionsinc.com)

## Replacement Seals For Travaini Liquid Ring Vacuum Pumps

### Metric Type VS21M

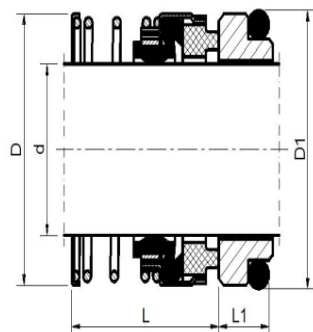

### Materials

Blister-Resistant Carbon Face  
Silicon Carbide - Seat  
Elastomers  
Metallurgy

| Seal Solutions Part No. | Travaini Part No. | RSD Part No. | Shaft d | Seal O.D. D | Seal W.L. L | Seat O.D. D1 | Seat Thk. L1 |
|-------------------------|-------------------|--------------|---------|-------------|-------------|--------------|--------------|
| SSI-8251                | 950022SAC915      | RSD-8251     | 22      | 33.60       | 27.50       | 37.00        | 10.00        |
| SSI-8251                | 950022SAC916      | RSD-8252     | 22      | 33.60       | 27.50       | 37.00        | 10.00        |
| SSI-8268                | 950024SAC915      | N/A          | 24      | 38.30       | 30.00       | 39.00        | 10.00        |
| SSI-8253                | 950028SAC915      | RSD-8253     | 28      | 42.50       | 32.50       | 43.00        | 10.00        |
| SSI-8253                | 950028SAC916      | RSD-8254     | 28      | 42.50       | 32.50       | 43.00        | 10.00        |
| SSI-8267                | 950030SAC915      | N/A          | 30      | 43.95       | 32.50       | 45.00        | 10.00        |
| SSI-8255                | 950035SAC915      | RSD-8255     | 35      | 49.10       | 32.50       | 50.00        | 10.00        |
| SSI-8255                | 950035SAC916      | RSD-8256     | 35      | 49.10       | 32.50       | 50.00        | 10.00        |
| SSI-8269                | 950038SAC915      | N/A          | 38      | 52.40       | 34.00       | 56.00        | 11.00        |
| SSI-8258                | 950043SAC912      | RSD-8258     | 43      | 58.80       | 34.00       | 61.00        | 11.00        |
| SSI-8258                | 950043SAC915      | RSD-8259     | 43      | 58.80       | 34.00       | 61.00        | 11.00        |
| SSI-8258                | 950043SAC916      | RSD-8260     | 43      | 58.80       | 34.00       | 61.00        | 11.00        |
| SSI-8266                | 950045SAC915      | RSD-8266     | 45      | 61.20       | 34.00       | 63.00        | 11.00        |
| SSI-8261                | 950055SAC915      | RSD-8261     | 55      | 71.65       | 34.50       | 75.00        | 13.00        |
| SSI-8261                | 950055SAC916      | RSD-8262     | 55      | 71.65       | 34.50       | 75.00        | 13.00        |
| SSI-8263                | 950075SAC915      | RSD-8263     | 75      | 96.80       | 44.40       | 97.00        | 15.30        |

### Features

|   |  |
|---|--|
| <p>To DIN 24960<br/>Bi-Directional<br/>Elastomer Bellows<br/>Unbalanced</p> | <p>Seal shown with LS3 Seat<br/>Can be provided with cup mounted Type N (Din) seat<br/>(Add C to end of part# for Cup Mounted Seat)<br/>Other sizes available upon request</p> |
|---|--|

Other materials & sizes available upon request